

INTRODUCING

Chiswell Court, Watford WD24 7PL

1 Bedroom Apartment - Purpose Built for sale

£180,000

Price



1 Bedrooms/1 Bathrooms EPC Rating: D

- Modern Ground Floor Apartment
- Entrance Hall
- Kitchen
- Re-fitted Shower Room
- Off Road Parking
- Security Intercom Entrance
- Lounge/Diner
- Double Bedroom With Fitted Wardrobes
- Council Tax Band C
- No Upper Chain

Floor Plan

GROUND FLOOR
393 sq.ft. (36.6 sq.m.) approx.

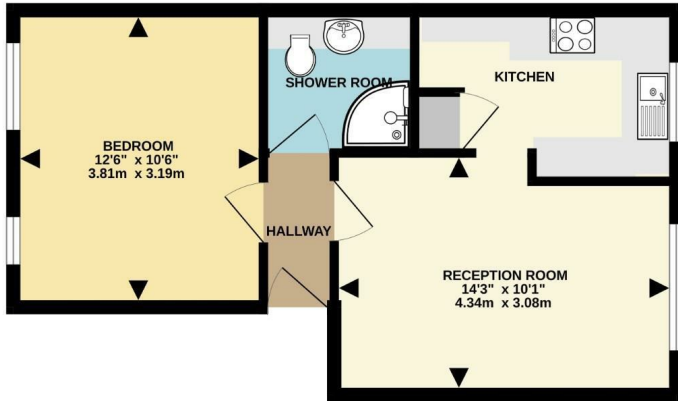

TOTAL FLOOR AREA: 393 sq. ft. (36.6 sq. m.) approx.
Whilst every attempt has been made to ensure the accuracy of the floorplan contained here, measurements of doors, windows, rooms and any other items are approximate and no responsibility is taken for any error, omission or mis-statement. This plan is for illustrative purposes only and should be used as such by any prospective purchaser. The services, systems and appliances shown have not been tested and no guarantee is given as to their operability or efficiency on the given.
Made with floorplan.co.uk

Map



Energy Efficiency

Energy Efficiency Rating		Current	Potential
Very energy efficient - lower running costs			
(92 plus) A			
(81-91) B			
(69-80) C			80
(55-68) D	65		
(39-54) E			
(21-38) F			
(1-20) G			
Not energy efficient - higher running costs			
England & Wales		EU Directive 2002/91/EC	



These particulars, whilst believed to be accurate are set out as a general outline only for guidance and do not constitute any part of an offer or contract. Intending purchasers should not rely on them as statements of representation of fact, but must satisfy themselves by inspection or otherwise as to their accuracy. No person in this firm's employment has the authority to make or give any representation or warranty in respect of the property.